



DATE: 4/2018

REVISED: 8/22/2018

TOPIC: Installation Instructions / Battery Disconnection / OCS System Reset

VEHICLE: 2018 Jeep Wrangler JL

The OCS sensor within the new JL seat is highly sensitive to movement. Because of this sensitivity, there is a chance that the OCS passenger light will remain on after completing a Katzkin leather installation and returning the seats to the vehicle. Follow these instructions as outlined, and you may not encounter this issue.

If you do encounter this issue, the Wrangler must be taken to your nearest FCA dealership for re-zeroing of the seats after the completed installation. Only the dealerships will have the tool necessary (Witech) for the OCS reset.

Please note that only Katzkin leather interiors for Mopar have been tested with this new process.

Battery Disconnection:

Please see Page 2. These instructions come directly from the FCA service manual.

OCS:

Gently remove the plug from the sensor when pulling the seat out of the vehicle. Avoid any unnecessary movement to the sensor while the seat is out of the vehicle. Keep the seat secure while transporting and do not drop the seat on the floor or workstation.

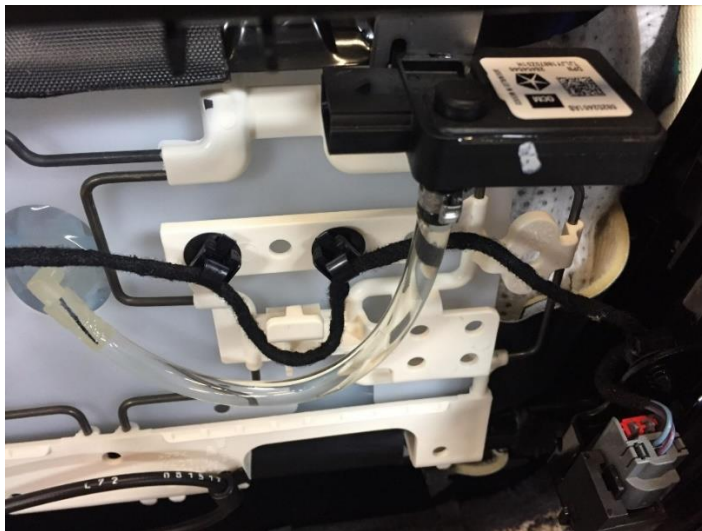

BATTERY DISCONNECT AND CONNECTION

The following procedure is the direct way to disconnect and Isolate the batteries for vehicles equipped with Electric Start/ Stop (ESS). Since the Supplemental battery is not easy to gain access to it and disconnect the Negative cable. The main battery connection has two negative cables on it plus the Intelligent Battery Sensor (IBS) that will all get disconnected in the procedure.

NOTE: If the battery negative cables are not isolated it will result in the system still having battery connection and a potential power spike or power of the system and can cause damage or deployment of air bags.

1. Remove the nut (2) for the supplemental battery negative cable and isolate the cable.
2. Remove the nut (3) for the main negative cable and isolate the cable.
3. If you loosen the nut (1) and isolate the negative cables it will not disconnect the battery connection for the supplemental battery and the system will have the ability to power up.
4. Disconnection of the IBS (4) will not isolate the battery system and will still allow the system to power up.

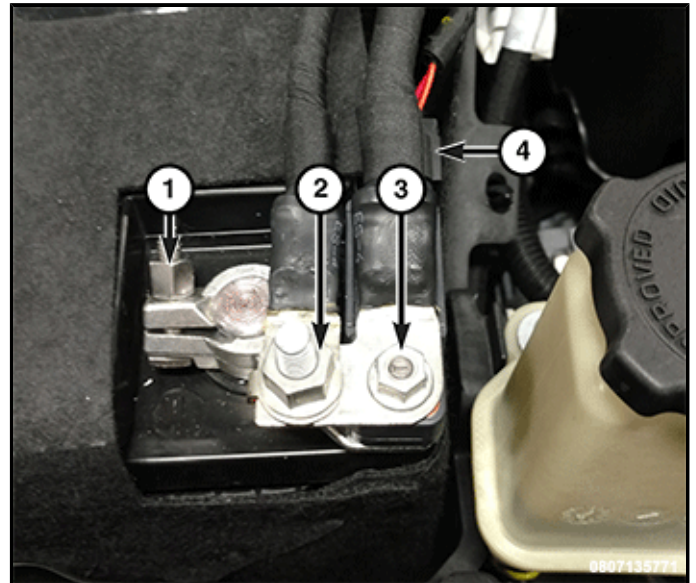

5. In this image you can see that the Supplemental negative cable (1) is disconnected and the main battery cable (2) is still connected but off the battery post. This is acceptable, but you will need to isolate the clamp from touching the negative battery post.

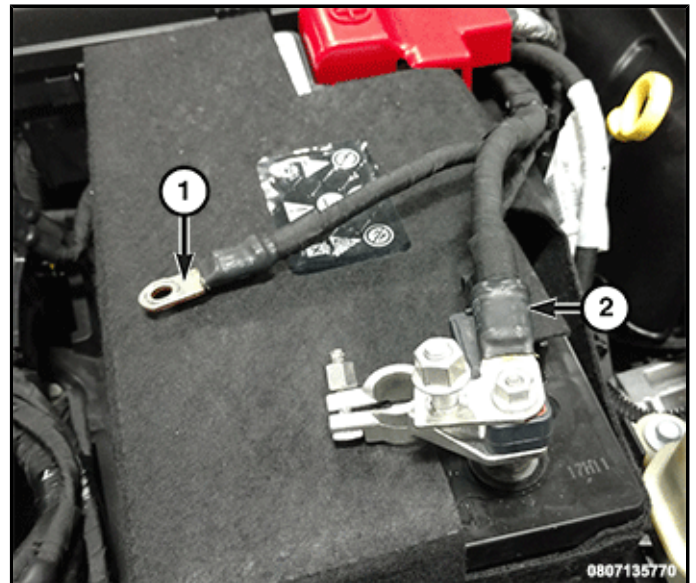

6. This image shows the battery system completely isolated and leaving the battery clamp (1) still in place and the IBS (2) still connected.

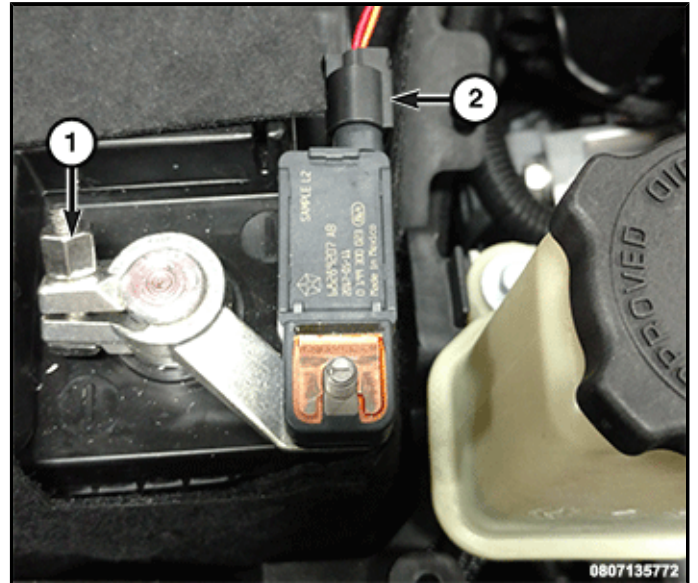

7. Once all repairs are completed, you will need to connect the cables and or the clamp and tighten to the proper (Torque Specifications).